

An aerial photograph of GIFT City at dusk. The central focus is a tall, modern glass skyscraper with a distinctive checkered pattern on its upper floors. To its left is another tall building with a blue and white facade. The city is surrounded by roads, parking lots, and some greenery. The sky is a deep blue with some clouds. An orange diagonal graphic element is on the right side of the image.

GIFT CITY- Enabling ecosystem for driving GCCs growth story

GCC functions, scenario and growth trends: An overview



Global Capability Centers are dedicated units of an organization which aims at centralizing multiple business functions to be delivered from one location for achieving cost efficiency & standardization

Standard benefits from Global Capability Centre



Reduced cost to serve



Efficient operations



Better visibility of operations



Retained organization's increased focus on business growth

Type of GCCs

Global hubs

Satellite Offices

Outpost/ Cluster offices

Outsourced Centres

GCC Scenario and Growth trends

India is home to 1700+ GCCs and 2975+ GCC units, employing over 1.9 Mn professionals across domains of AI, Big Data and Analytics, IoT, Cybersecurity and Robotics.

Over 500 centres dedicated to AI and Machine learning showcases India's commitment to embracing future technologies.

174 Fortune Global 500 companies have GCCs in India (as of June 30, 2025)

GCC revenue of USD 64.6 Bn (FY 2024)

Broad sectoral strength with sectors like IT/ITeS: 42%, BFSI (21%), Retail/CPG (14%), Healthcare (12%), and Automotive (11%) lead in GCC adoption

Number of GCCs grew at a CAGR of 4.6% between FY2019-FY2024.

Growth attributed to reasons being shift towards Specialization, focus on partnerships and evolving digital landscape

GCCs Regional concentration in India and future potential

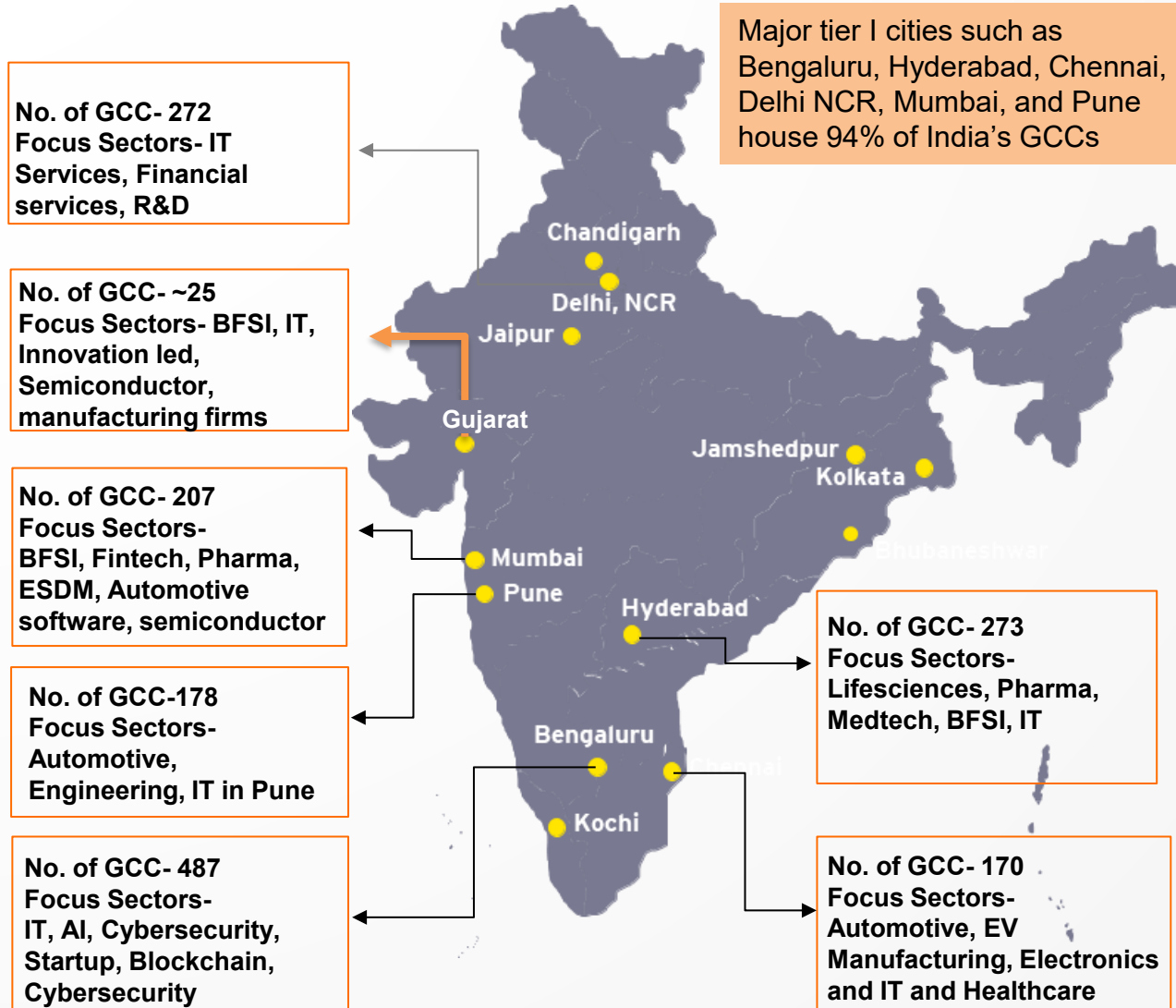

GCCs: The NextGen Strategy

Comprehensive framework giving rise of Tier-2 Cities as preferred GCC destinations like Ahmedabad, Jaipur, Bhubaneswar, Indore, Coimbatore, and Vizag.

India having an edge through competitive operational costs, highly skilled workforce, world-class infrastructure, and conducive policy incentives

Strategic Value Creation

Evolve from cost-saving hubs to centres of strategic value, driving product innovation, research and development,

Rapidly growing digital innovation and startup growth particularly in areas like AI, machine learning, data analytics, and cloud computing will give impetus to GCC ecosystem

Talent Development

Reskilling and Upskilling of workforce with focus on emerging technologies, automation and leadership skills

Ahmedabad, Coimbatore, Kolkata and Thiruvananthapuram account for 50% of the GCC units situated in India's Tier 2 cities

Impact of GCC industry in India



GCC are making considerable impact across economic, human capital, innovation & ecosystem, reputational, environmental and social dimensions of India



Economic

- \$4-5.6 Bn+ in taxes, corporate and personal
- Output of \$35.9 Bn i.e. 1% of the GDP
- Generated indirect employment of 5.5mn i.e ~4x to direct employment



Social

- Betterment of ~1.7mn households through women empowerment
- 40% spend in education benefitting ~7mn underprivileged children



Environmental

- 9/10 of the largest GCCs by headcount are housed in LEED certified premises
- ~600mn kWh energy consumption from renewable sources
- ~1bn pages and 13-15k trees saved



Human Capital



- Trained ~200K+ in futuristic skills since 2015
- 80-90K people hired in start-ups founded by ex GCC employees
- Represent 40% of India's most inclusive companies

Innovation & Ecosystem



- 10-15% share in start-up leadership in India
- Promoting innovation & entrepreneurship through NITI Aayog
- 300 start-ups engaged as vendors generating 15mn+ in revenue for start-ups

Reputational



- India being renowned as the global digital and R&D hub
- Engine room for global operations
- Hub for scalable & frugal innovation

Typical parameters for consideration for GCC setup location



Listed below are key parameters considered for GCC setup location with Human Resources and Cost elements being most important

2. Cost elements

H

- Building maintenance costs
- Average office space rentals
- Rental inflation
- Average annual CTC & inflation
- Utility costs

3. Human Resources

H

- Academic profile
- Current size of workforce
- Annual growth rate
- Average attrition rates
- Workforce experience level

4. Infrastructure

M

- Availability of incubation centres
- Telecom – total tower count
- Ease of mobility
- Number of direct international air-routes

1. Business Environment

M

- Impact of government policies and tax incentives
- Ease of doing business / perception
- Number of days lost to natural disaster & direct employee action
- Disaster index

5. Social environment

L

- Quality of life index
- Cost of living index
- Crime rate index
- Air quality index
- Annual talent inflow



Typical Weightages

Low Medium High

GCCs in GIFT City: In Focus

Finance Minister, Smt. Niramala Sitharaman reviews progress of GIFT IFSC and interacts with 21 key market participants from various sectors on 26 June 2025

<https://www.pib.gov.in/PressReleasePage.aspx?PRID=2139983>

Finance Minister highlights GIFT City's potential at the CII GCC summit



https://www.linkedin.com/posts/gujarat-international-finance-tec-city-gift-city-india-s-first-operational-smart-city-and-ifsc_at-the-cii-global-capability-centers-gcc-activity-7350704626616139776-Sw1d

GIFT City is the Next Big Move for GCCs!

32,938 followers
1mo •

GIFT City emerges as Tier-II magnet for GCCs in India.

A'bad-GIFT City zone emerges as Tier-II magnet for GCCs: Report

State Policies, GIFT City's Tax Holiday Lure Global Firms

Niyati Parikh@timesofindia.com

Ahmedabad: The Ahmedabad-Gandhinagar-GIFT City belt is rapidly rising as India's most promising Tier-II zone for global capability centres (GCCs), fuelled by infrastructure, state incentives and a growing pool of skilled talent. According to an Aug 2024 report by global consulting firm Zinnov, Ahmedabad ranks No. 1 among 20 Tier-II cities in ecosystem favourability for GCCs.

Already home to over 35 GCCs and global in-house centres (GICs), 25-plus service providers, and more than 60 startups, Ahmedabad has become the largest GCC hub outside India's Tier-I metros. GIFT City, in particular, has become a magnet for global firms eyeing high-value innovation, IT, and back-office operations. In the past year, new entrants such as Infineon Technologies, a chipmaker, and Technip Energies, an energy transition firm, set up under the non-financial services (Non-FS) category, joining established players like IBM, Oracle, Capgemini, Google, TCS, Infosys, and Wipro.

With more than 450 IFSC units and 25% annual growth, GIFT City's appeal continues to rise. The zone's regulatory clarity, scalability, and business-ready infrastructure are drawing major multinationals including Bank of America, SP Global, Ambeal Pharmaceuticals, Kraft Heinz, and Thomson Reuters.

Policies like the Gujarat Semiconductor Policy 2022-27 and the recently introduced GCC Policy have further fuelled interest from tech and ESDM players, offering target

INDIA'S HOTTEST TIER-II GCC HUB

Ecosystem at a glance

- 35+ global capability centres (GCCs) and global in-house centres (GICs)
- 25+ IT and business service providers
- 60+ startups driving innovation
- 350+ units at the International Financial Services Centre
- 25% YoY growth in IFSC units

What's driving the growth?

- 10-year tax holiday under Section 80IA at GIFT IFSC – only such benefit in India
- Gujarat govt incentives
- Reduced stamp duty
- Discounted power tariffs
- 100% PF reimbursement for women hires
- World-class infrastructure and scalable office spaces
- Affordable housing in Gandhinagar: Better quality of life

Sources told TOI that Telenor Digital is also expected to join the league. "GIFT City IFSC offers a 10-year tax holiday under Section 80IA – the only such benefit in India. Add to that Gujarat's industry-friendly policies, reduced stamp duty, discounted power tariffs, and PF reimbursements of up to 100% for women, and the zone is a compelling proposition," said Jaimin Patel, Partner, EY.

While entry-level talent availability is strong, experts acknowledge the need for companies to nurture mid- and senior-level professionals. However, the region scores high on quality of life, affordability, safety, and overall ease of living – factors that increasingly matter in global location strategies.

Technip Energies is one of the recent global players to bet on the region. "Our GIFT City office, Technip Energies' fourth base in India, exceeded expectations," said B V Ramakrishna, director of the Ahmedabad operating centre. "With strong engineering talent, proximity to key clients like Reliance and Adani, and solid infrastructure, we are onboarding 50-60 employees a month and are on track to hit 400 by Q4. GIFT City's support, especially in securing additional space, has been excellent."

As more companies evaluate India's next wave of opportunity the Ahmedabad-Gandhinagar-GIFT City belt is making a strong case, offering Tier-I aspirations with Tier-II economics.

You and 1,295 others

9 comments · 44 reposts

Like Comment Repost Send



02

GIFT CITY
**“House of
opportunities”**

About GIFT City

India's 1st Operational Smart City & IFSC

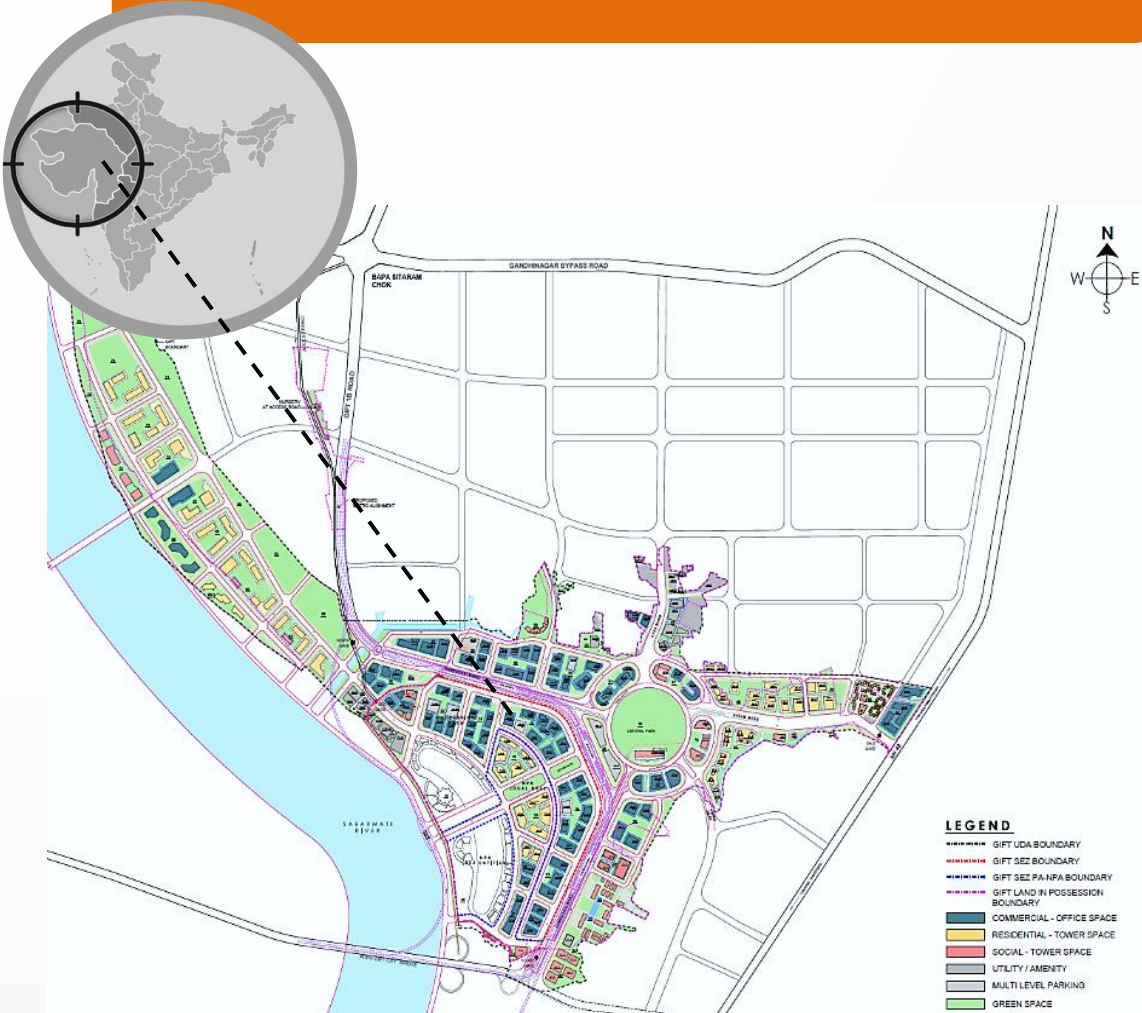

Gift City is a Greenfield Smart City developed on 886 acres of land. It has two zones: DTA (Domestic), SEZ (IFSC)



886 acres land area



625 acres DTA



261 acres IFSC/SEZ



14 Foreign Banks & 17 Domestic Banks



Cumulative Banking Transaction: \$ 1,321 Bn



Asset size of Banks: \$ 90 Bn

Tri-City Hub: A convergence of opportunity

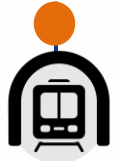

Metro connectivity

between Ahmedabad, GIFT City & Gandhinagar



15 mins

from the proposed bullet train terminal



20 mins - Ahmedabad's international and domestic airport



Along **National highway 48**
(Delhi- Mumbai Industrial Corridor)

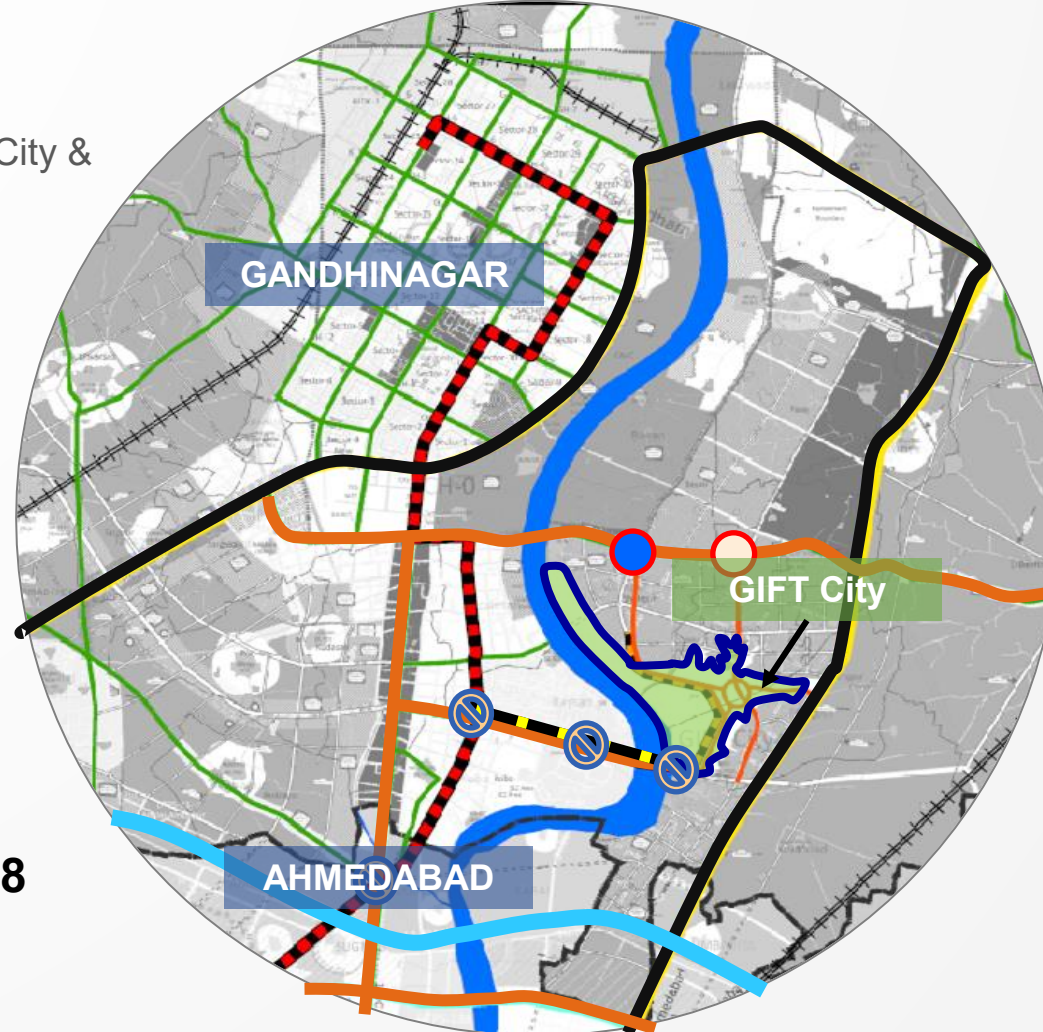

24 EV

buses covering Ahmedabad, Gandhinagar & GIFT City



15 Mins

from the nearest Railway Station



1.5 hr. flight

Connecting to major domestic destinations



First

Operational Smart City
Green Infrastructure



GIFT City: Integrated development



**COMMERCIAL
BUSINESS DISTRICT**



**DEDICATED
RESIDENTIAL ZONE**



**SOCIAL
INFRASTRUCTURE**



**RETAIL CUM
ENTERTAINMENT
HUBS**



25 operational buildings



47 buildings under planning and construction stages



+700 offices



+ 25,000 people

GIFT City: State-of-the-art infrastructure facilities



Automated Waste
Collection & Segregation
Plant



District Cooling
Plant



Underground Utility
Tunnel



Water Treatment
Plant

Upcoming Social
Infrastructure



Riverfront Development

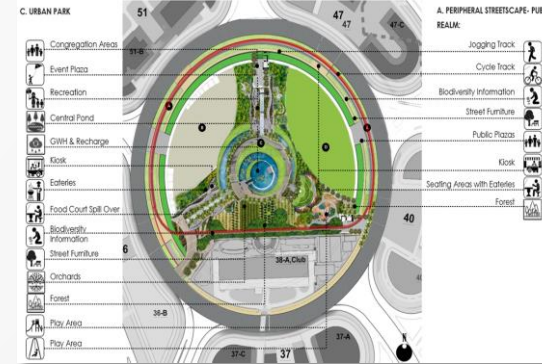

Central Park



Lilavati Hospital

Knowledge corridor and Talent accessibility

Location	Artificial Intelligence & Machine Learning		Robotics		Blockchain & Cloud Computing		Data Science		Cyber Security		Information Technology & Computer Engineering	
	Colleges	Graduates	Colleges	Graduates	Colleges	Graduates	Colleges	Graduates	Colleges	Graduates	Colleges	Graduates
Ahmedabad	18	950	2	143	Nil	Nil	4	245	2	154	53	7935
Gandhinagar	3	154	1	75	1	34	Nil	Nil	1	34	28	3687
Surat	8	442	1	68	2	102	2	102	3	136	36	3217
Vadodara	3	1756	1	68	4	264	2	60	3	541	34	6956
Other Cities	9	573	1	75	1	40	4	237	3	196	121	10441
Total	41	3,875	6	429	8	440	12	644	12	1,061	272	32,236

AROUND GIFT CITY

Key Institutions



Foreign Universities in GIFT IFSC



GIFT IFSC has emerged as India's first gateway for international education aligned with global finance and technology.



Deakin University (Australia) – Launched July 2024

Courses- Masters of Business Analytics, Master of Cybersecurity



University of Wollongong (Australia) – Launched November 2024

Courses: Financial Technology, Data Analytics, Certification in Computing & FinTech

Approved & Launching in 2026:



Coventry University (UK)

Courses: BSc in Business and Finance, International Business Management



Queen's University Belfast (UK)

Courses: AI for Business, Business Analytics, Environmental Engineering

Academic Infrastructure Support Providers

Global University Systems (UK)

GEDU Education (UK)

Education Centre of Australia

International Fintech Innovation & Research Centre



GIFT City along with GoG and Asian Development Bank is developing International Fintech Institute.



Training



Accelerator



Incubation



Research

Institutional Partners



**Ahmedabad
University**



IIT Gandhinagar
Indian Institute of
Technology Gandhinagar



UC San Diego

Incubation Partner



PLUGANDPLAY

Space availability in GIFT City

Upcoming commercial projects in GIFT City

Special Economic Zone

IFSCA Tower

Savvy Pragya
2

Flexone

Rajyash One

Shivalik Trophy

Shilp Twin
Towers

Suma Shilp

The Goodwill
Tower

Brigade II

Total built up area: 5.88mn sq ft

Domestic Tariff Area

Shivalik Curve

Shilp Centrica

Regalia

Narmada

Total built up area: 2.14mn sq ft

Enabling Ecosystem for GCC in GIFT City

On November 12, 2020, the International Financial Services Centres Authority (IFSCA) introduced the Global In-House Centres (GIC) Regulations, establishing a framework for the recognition and operation of GCCs.

Strategic Location

GIFT IFSC is strategically located between Gandhinagar and Ahmedabad, which are the capital and financial epicentres of Gujarat, a burgeoning development-focused state in India. GCCs stand to benefit from GIFT City's proximity to major cities like Ahmedabad and access to an international airport which facilitates business operations and connectivity.

Infrastructure facilities

GIFT IFSC offers world-class infrastructure and modern office spaces designed specifically for global companies. State-of-the-art buildings in GIFT City are equipped with advanced technology and amenities necessary for GCC operations. As India's first operational smart city, GIFT City has immense potential as an innovation hub and gateway to global domination. A Greenfield development, GIFT City has robust capacity to accommodate future expansion plans.

Enabling Ecosystem for GCC in GIFT City

GIFT Advantage

GIFT IFSC boasts a proactive and industry-oriented financial regulator suitable for GCC operations. It offers the opportunity to be present in a fast-growing global financial center featuring light-touch regulation. GIFT IFSC unlocks the ability to partner with the fintech ecosystem in an international financial center.

Gujarat GCC Policy

Gujarat's GCC Policy drives global service hubs with incentives such as 25% CAPEX support, up to 15% OPEX support, 100% electricity duty exemption for 5 years, and dedicated skill development programs—positioning the state as a top destination for GCC investments.

Regulatory Ease

Designed to be at par with global financial and technology hotspots, GIFT IFSC operates under a special regulatory framework, providing a business-friendly environment for GCCs. Simplified procedures and a single-window clearance system streamline the establishment and operation of GCCs.

Enabling Ecosystem for GCC in GIFT City

Talent pool and educational institutions

Gujarat has a strong talent pool with access to top-tier educational institutions and technical universities. GIFT City offers GCCs collaboration opportunities with educational institutions for talent development and research partnerships. Gujarat has emerged as the new center for IT-BPM industry in the western region, in terms of both supply of and demand for talent. Gujarat's employability rate is amongst the top 10 states in India, and the highly skilled workforce available here will tremendously benefit GCCs.

Ahmedabad, Gandhinagar and Vadodara are hubs for ITeS and GIFT City is well-positioned to leverage the benefits offered by these cities.

Connectivity and accessibility

GIFT IFSC is well-connected through air, road, and rail networks, making it easily accessible for domestic and international travel. Direct flights to major cities in India and international destinations. Enhance connectivity for GCCs. Central locations in both North and South India are accessible in just 1.5 hours by direct flights, with GIFT City ensuring optimal access to 47 destinations in 9 countries, via direct flight and one-hop connection to a majority of global destinations.

Enhanced connectivity through metro, high speed rail, and the booming Mumbai – Delhi Industrial Corridor. Gujarat features the highest number of operational ports and commercial cargo ports in India, with 42 ports including 1 major port.

Enabling Ecosystem for GCC in GIFT City

Collaboration & networking

GIFT IFSC hosts various industry events, conferences, and seminars, providing opportunities for collaboration, knowledge-sharing, and networking. The presence of financial institutions, banks, and multinational companies facilitates partnerships and business synergies. Gujarat is home to major names such as Tech Mahindra, TCS, Infosys, Capgemini, State Bank of India, ICICI Bank, Axis Bank, HDFC Bank, IIFL, S&P Global Market Intelligence, and Bajaj Finserv, among others.

Conducive ecosystem

GIFT IFSC has a supportive ecosystem with regulatory authorities, government agencies, and service providers catering to the needs of GCCs. Optimal access to legal, financial, and advisory services, which are essential for smooth operations and compliance, is available within GIFT City

Economic stability and growth

Gujarat is known for its stable political environment, investor-friendly policies, and robust economic growth, making it an attractive center for GCCs. GIFT IFSC benefits from the state's overall economic stability and commitment to promoting globally relevant services.

GIFT City IFSC: Enabling Fiscal & Non-Fiscal Incentives

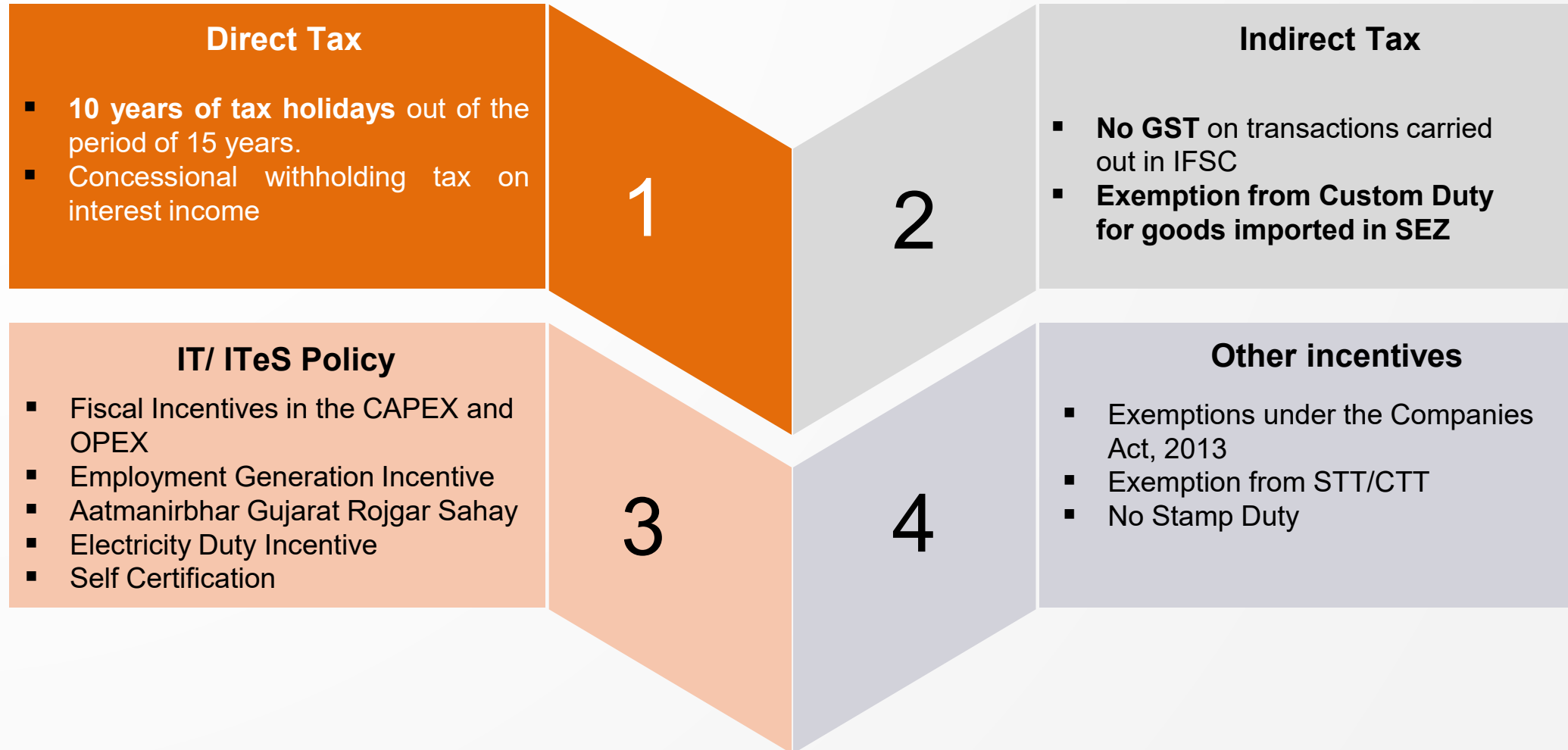

Key data points across critical factors for major Indian cities



The below table includes comparison of key data points across business, talent, cost and infrastructure factors for major Indian cities

	Key parameters	Ahmedabad	Bangalore	NCR	Mumbai/Pune	Chennai	Hyderabad
Business Factors	Innovation Index	23.63	42.5	46.6	38.03	37.91	33.23
	Disaster recovery index	22.5	10.5	10.5	15.5	23.5	10.5
	Ease of doing business Ranking	Top Achiever	Top Achiever	Emerging Business Ecosystem	Achiever	Top Achiever	Top Achiever
Human Resource & Cost factors	Average annual CTC (2-5 years exp)*	\$11,450 – \$ 18,000	\$ 12,000 - \$ 22,000	\$ 12,000 - \$ 22,000	\$ 12,500 - \$ 23,500	\$ 10,000 - \$ 21,000	\$ 11,000 - \$ 21,000
	Average annual CTC (8-10 years exp)*	\$21,000 – \$27,000	\$ 26,000 - \$ 35,000	\$ 26,000 - \$ 38,000	\$ 27,000 - \$ 40,000	\$ 25,000 - \$ 32,000	\$ 26,000 - \$ 33,000
	Average operating expenses (per FTE/ year)	\$ 1,800 - \$ 2,100	\$ 2,800 - \$ 2,950	\$ 2,300 - \$ 2,500	\$ 2,900 - \$ 3,100	\$ 1,900 - \$ 2,000	\$ 1,900 - \$ 2,000
	Labor Market Capacity						
	Total size of workforce (in lakhs)	~35.1	~65.5	~37.6	~77.55	~44.0	~40.1
	Cost of living index	25.99	28.2	28.23	29.33	26.08	26.61
Infrastructure factors	Average rental rates (per sq. ft/ year)	\$ 6.30	\$ 13	\$ 19	\$ 18	\$ 10	\$ 10
	Total area of facility (assuming 200 FTEs)	~ 20,000 sq. ft					
	Average rental rates (per FTE/ year)	\$ 950	\$ 1,300	\$ 1,900	\$ 1,800	\$ 1,000	\$ 1,000

Favourable Balanced Unfavourable

Target Sectors and functions for GCCs in GIFT City

Attributes

Potential Sector	Potential GCC functions	State Vision 2047	Gujarat Competitiveness	State Enablers	Sector Outlook & Trends	GIFT Ecosystem
BFSI	Investment Operations Support, Digital and Emerging Tech Labs	●	●	●	●	●
Pharmaceuticals	Digital Health & Med-Tech, Innovation Labs & R&D Technology, Precision Medicine	●	●	●	●	●
Textile	Smart Textiles, 3D textile simulation, Fabric Engineering	●	●	●	●	●
Automobiles & EV	Electric Vehicles (EV) & Battery Innovation, Emissions compliance, Vehicle Simulation Labs	●	●	●	●	●
Renewable Energy	Green Financing, Smart Grid & Energy Systems, Clean Energy R&D and Innovation Labs	●	●	●	●	●
Semiconductors	Advanced Packaging, Regulatory Compliance, Electronic Design Automation Lab	●	●	●	●	●
Chemicals and Petrochemicals	Speciality Chemicals, Petrochemical Derivatives, Digital Labs & Industry 4.0	●	●	●	●	●
Ports and Shipping	Digital Port Infrastructure & Smart Logistics, Autonomous & Remote Shipping Systems, Incubation Centres	●	●	●	●	●
Sports	Athlete Performance & Sports Science Analytics, Esports & Gaming Innovation	●	●	●	●	●
Gems and Jewellery	Product Design & CAD Support, Gemstone Analytics & Quality Labs	●	●	●	●	●
IT&ITES	Cybersecurity Operations & Cloud Infrastructure, AI labs & Industry 4.0	●	●	●	●	●

Key Institutions at GIFT City

Banking

Alternative Investment Funds

Fintech Companies

Ancillary Services

Aircraft Leasing

Finance Companies

Insurance Companies

Capital Market

DTA Companies

GCCs/GICs

BATF

Leading TechFin institutions in GIFT City IFSC in last 1 year

Wipro has received approval for TechFin operations - **~500 employees.**



Infosys has set up TechFin operations with **600 employees.**



Cognizant has set up TechFin operations starting with **600 employees.**



Hexaware has commenced Techfin operations and plan to expand to **~500 employees.**



Aurionpro has set up its operations and plan to expand to **~150 employees.**

Intellect design is launching 5 products and plan to appoint to **~150 employees.**



Various FinTech's at GIFT City IFSC

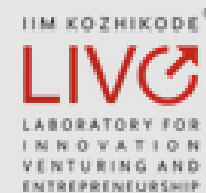
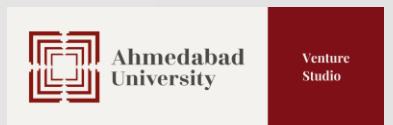

Leading companies in GIFT City-DTA Area

Leading GCCs in GIFT City



Germany based Semiconductor & Systems Solutions company
~750 Employees



France based energy transition company
~500 Employees



Canada based technology solutions company
~500 Employees



Tata Electronics has set-up chip designing operations in GIFT City

Tech/ CoEs



US based IT service and management consulting company with **~750 Employees**



France based information technology services and management company
Expansion plan of **~1000 Employees**



NASSCOM has established **Centre of Excellence for deep tech innovation** in GIFT City



IBM expands consulting arm in GIFT City along with **software labs**

Gujarat GCC Policy (2025-2030)

Objective

- ▶ Establish Gujarat as preferred GCC hub and Promote high-value jobs
- ▶ Foster innovation and digital transformation
- ▶ Enhance infrastructure and connectivity
- ▶ Sustain economic growth and global competitiveness

Applicability

- ▶ GCCs – Centres established to enhance operational efficiency. Centres support their parent organization by managing various global functions, driving innovation, and delivering value across sectors like Banking, Capital Markets & financial Services, Engineering R&D, Retail & e-commerce, etc.

Vision

- ▶ Strengthen Gujarat's position by attracting multinational corporations to setup GCCs.
- ▶ Attract a minimum of **250 new GCC units**
- ▶ Generate more than **50,000 employments** in the state
- ▶ Attracting an investment of **INR 10,000 crore** in the state.

Eligible Units

- ▶ **Eligible Units** means existing and new units setting up GCC and having minimum 50 employees on its payroll.
- ▶ **Non Mega** - GFCI of less than INR 250 Crores
- ▶ **Mega Project**: Minimum GFCI of INR 250 Crores or minimum direct employment of 500 persons.

Incentives

S. no.	Investment category	Incentive header	Benefits (INR crore)	Overall ceiling limit
1		Capex subsidy	Up to 20% on construction and purchase of building*	INR 50 crore
2	GCCs < INR 250 crore	Capex subsidy	Up to 30% on computers, software, networking related hardware	
3		Operational subsidy	Up to 15% of operational expenditure	INR 20 crore per annum (bandwidth and cloud rental restricted to 35% of opex and capped to INR 7 crore per annum)
4		Capex subsidy	Up to 20% on construction and purchase of building*	INR 200 crore
5	GCCs > INR 250 crore and employment of 500 people	Capex subsidy	Up to 30% on computers, software, networking related hardware	
6		Operational subsidy	Up to 15% of operational expenditure	INR 40 crore per annum (bandwidth and cloud rental restricted to 35% of opex and capped to INR 14 crore per annum)
7	All GCCs	Employment generation incentive	Up to 50% reimbursement of monthly CTC for one year	Up to INR 50,000 per male employee and up to INR 60,000 per female employee
8	All GCCs	Interest subvention	Up to 7% interest subsidy	Capped to INR 1 crore per annum for five years
9	All GCCs	Aatmanirbhar Gujarat Rojgar Sahay	Up to 75% Employees' Provident Fund (EPF) reimbursement for male employees and 100% EPF reimbursement for female employees	Capped to 12% of employee's basic salary + dearness allowance
10	All GCCs	Electricity duty exemption	100% reimbursement of electricity duty paid for five years	NA
11	All GCCs	Quality certification	Up to 80% of quality certification fees	Capped to INR 10 lakh

Source: Department of Science and Technology – Government of Gujarat

*The expenditure incurred under GFCI towards the construction of new buildings shall be capped at INR 3,000/sq. ft. of built-up area, applicable for a total built-up area computed at 60 sq. ft. of built-up area per employee on the payroll of the eligible unit.

Government of Gujarat IT/ITes policy

01

- 15% of OPEX (available for 5 years)
- Upto INR 40 Cr. with GFCI > INR 250 Cr.
- Upto INR 20 Cr. with GFCI < INR 250 Cr.

02

Atmanirbhar Rojgar Sahay (ARS) - Reimbursement of employer contribution to PF upto 12% (5 years)

03

Employment Generation Incentive - 50% of one month employment cost to company (one-time)

04

- Capital subsidy – 25% of Eligible CAPEX (one-time)
- Upto INR 200 crs with GFCI > INR 250crs
- (Mega Project) Upto INR 50 crs with GFCI < INR 250 Cr.

05

Provision of direct benefit transfers of up to INR 50,000 for courses in information and communication technology



Case study

Use Case

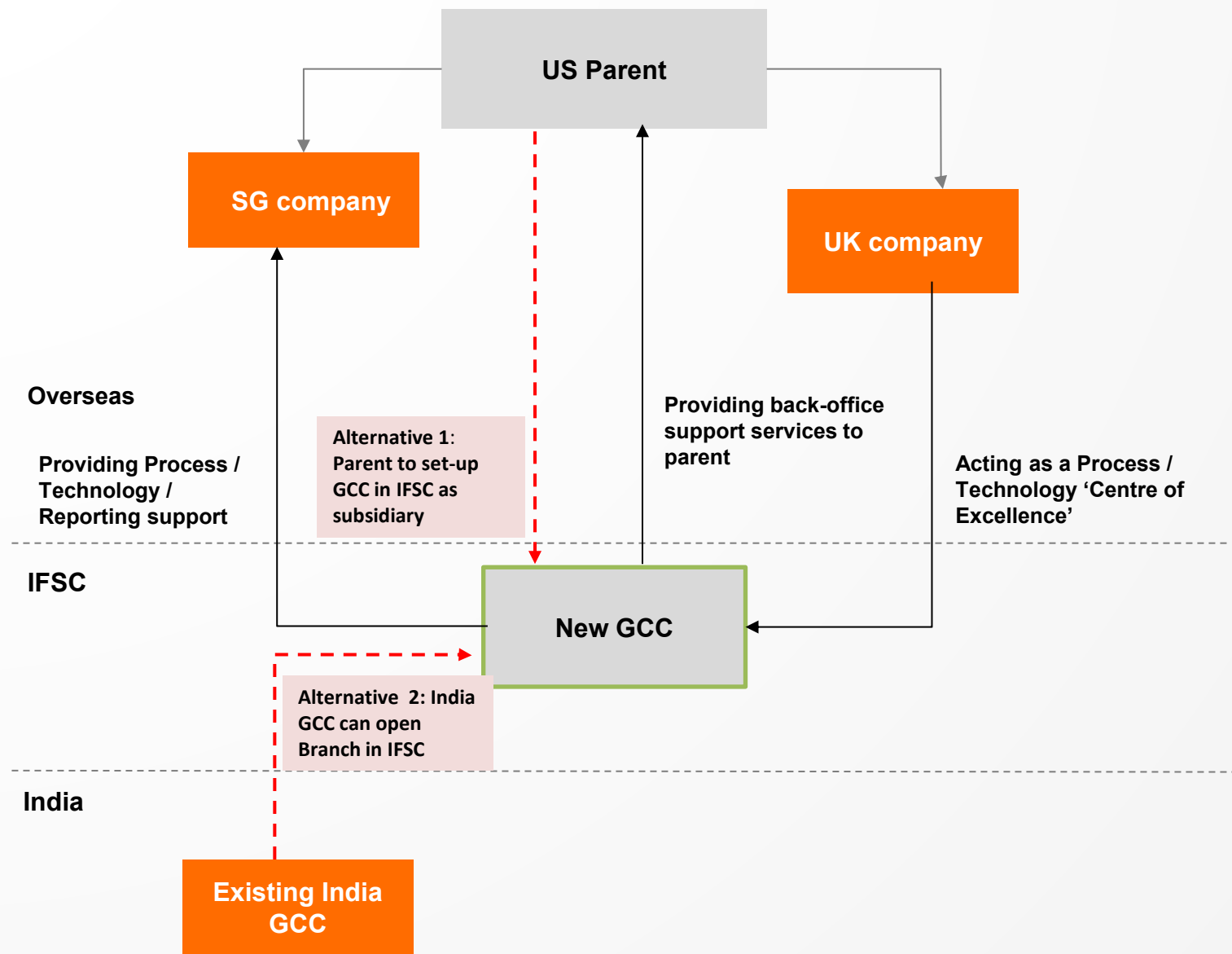

Establishing a GCC in IFSC:

Client overview

A top-tier multinational bank with diversified operations across retail banking, wealth management, and insurance, sought to enhance operational efficiency, drive innovation, and ensure regulatory compliance through a strategic offshore GCC setup

Business challenge:

- Rising operational costs and limited scalability in core markets
- Need for accelerated digital transformation and data-driven decision-making

Opportunities:

- Agile operating model with cross-functional squads
- Economies of scale through centralized operations
- Enhanced productivity through automation and digital tools
- Build and house 'Intellectual Property' in India

Potential impact

Metric	Before GCC	After GCC (Year 2-4)
Operational Cost	100% baseline	↓ 35%
Product launch cycle	6 months avg	↓ 40%



GET INDIA ADVANTAGE BY SETTING UP IN GIFT CITY

31

“GIFT HOUSE”, Block-12, Road 1-D, Zone - I,
GIFT SEZ, GIFT City, Gandhinagar - 382355, Gujarat, INDIA.



www.giftgujarat.in